

Soils Map

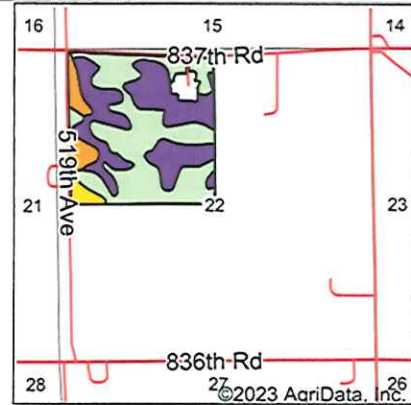

State: **Nebraska**
 County: **Antelope**
 Location: **22-23N-7W**
 Township: **Logan**
 Acres: **136.82**
 Date: **6/15/2023**

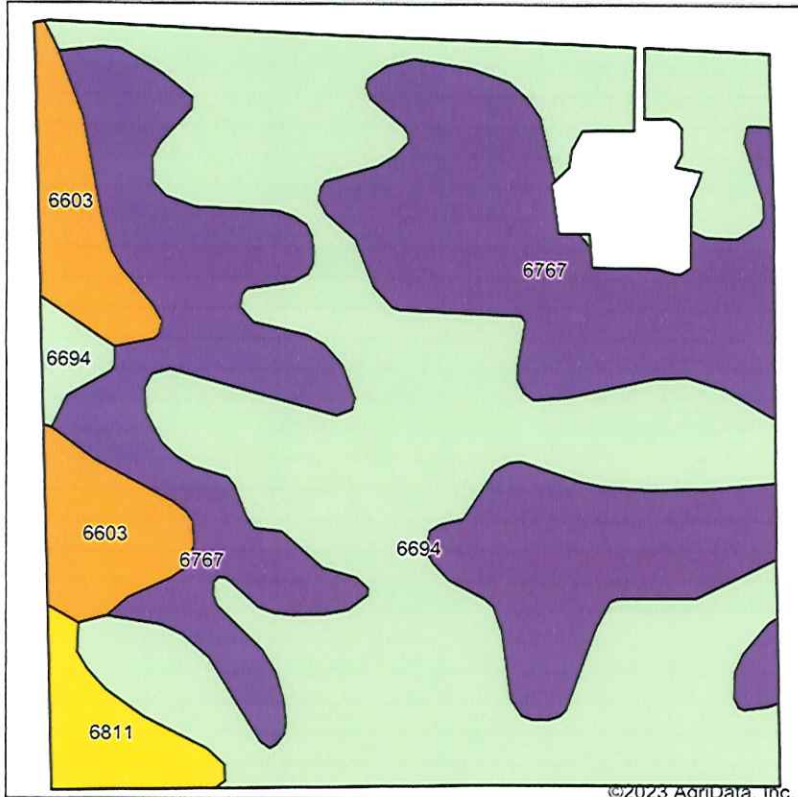

Soils data provided by USDA and NRCS.

©2023 AgriData, Inc.

© AgriData, Inc. 2023

www.AgriDataInc.com

Area Symbol: NE003, Soil Area Version: 24

| Code | Soil Description | Acres | Percent of field | SRPG Legend | Non-Irr Class *c | Irr Class *c | SRPG | *n NCCPI Overall | *n NCCPI Corn | *n NCCPI Small Grains | *n NCCPI Soybeans |
|-------------------------|--|-------|------------------|-------------|------------------|--------------|-------------|------------------|----------------|-----------------------|-------------------|
| 6694 | Crofton-Nora complex, 6 to 11 percent slopes, eroded | 70.53 | 51.5% | | Ive | Ive | | 65 | 60 | 41 | 64 |
| 6767 | Nora silty clay loam, 6 to 11 percent slopes | 52.66 | 38.5% | | IIle | Ive | 59 | 74 | 62 | 47 | 74 |
| 6603 | Alcester silty clay loam, 2 to 6 percent slopes | 9.63 | 7.0% | | Ile | IIle | 73 | 75 | 74 | 52 | 72 |
| 6811 | Moody silty clay loam, 2 to 6 percent slopes | 4.00 | 2.9% | | Ile | IIle | 66 | 75 | 75 | 54 | 74 |
| Weighted Average | | | | | 3.42 | 3.90 | 29.8 | *n 69.5 | *n 62.2 | *n 44.5 | *n 68.7 |

*n: The aggregation method is "Weighted Average using all components"

*c: Using Capabilities Class Dominant Condition Aggregation Method

Soils data provided by USDA and NRCS.